

WALLS



WALLS





Greenscreen® panels transform building facades into vibrant, energy-efficient displays. They support climbing and deciduous vines that shade structures in summer and allow sunlight to heat buildings in winter.

Panels can be fabricated for flat or curved walls, matching building contours. The system’s modular design ensures a seamless and secure installation.

Our fabrication team can modify panels to fit unique shapes. Meet with an Advisor to discuss your project.

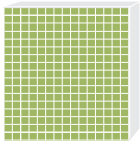

Add panels for continuous coverage

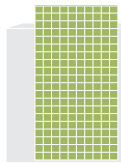

Cantilever up to 20%



Curve to match contours

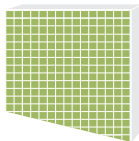

Angle cut any edge

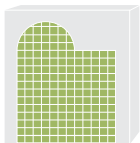

Fabricated to meet design needs

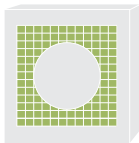

Cut out for aesthetic or functional reasons



## WALL MOUNTING

Use Greenscreen® mounting clips to secure panels to building facades. There are two options for standard wall mounting clips designed to keep trellises in place. Custom clips can be designed to accommodate unique conditions.

### TRIM OPTIONS

Each panel has four edges that can be finished with Channel Trim, Edge Trim, or left untrimmed. While exterior edges should have trim, adjoining edges in tiled installations don't require trim. When selecting trim, note that the Channel Trim should not be specified for the bottom edge. Trim adds 1/8"; adding trim on all four sides would add 1/4" to both width and length.

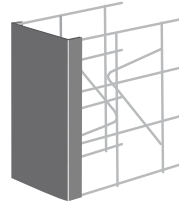

Channel Trim 5104

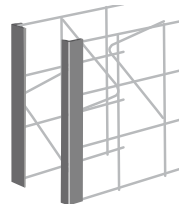

Edge Trim 5105

#### CLIP 5132R Close fitting clip.

+/-1" airspace between the wall and the back of the panel.

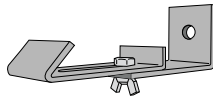

#### CLIP 5132G Deeper clip.

+/-5" airspace between the wall and the back of the panel.



#### CUSTOM CLIPS

We can design custom clips to accommodate unique site conditions.

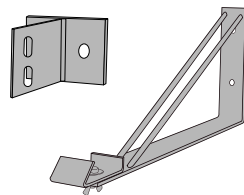

### CURVED WALLS

When fabricating Greenscreen® trellis to curved facades, the Cut-to-Curve method is used.

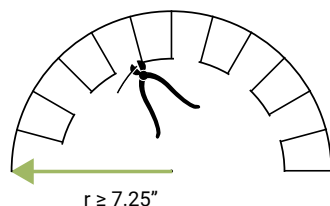

Small sections of the grid panel are removed to create a flexible trellis that can curve to meet field conditions. Information about Crimp-to-Curve can be found in the Fencing section on page 18.

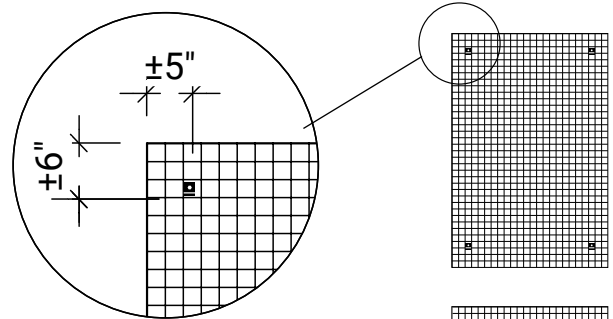

### CLIP LOCATION

We recommend that clips are placed ~5" from a vertical edge between two vertical trusses, and ~6" from a horizontal edge.

### MOUNTING CONFIGURATION

A number of factors can influence the quantity of clips and mounting location, but a good rule of thumb is to use 4 or more clips on a 4' x 6' panel, 6 or more for a 4' x 8' panel, and 8 or more for a 4' x 12' panel.

Work with one of our Advisors to create plans for your Greenscreen trellis project. Installation instructions will be provided.

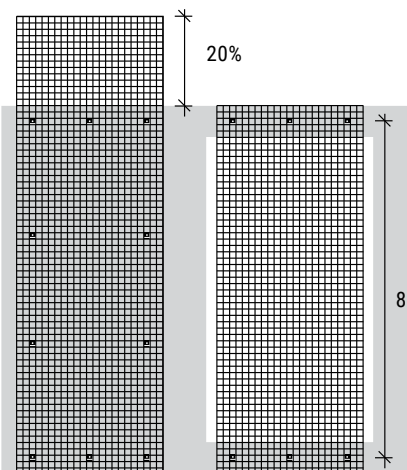

### OPEN SPANS & CANTILEVERING

Span a vertical opening up to 8' unsupported.

Cantilever up to 20% of panel length.